



Sensedge Go

User manual and installation guide



Contents

What's Included	3
Important Safeguards	3
Getting Ready for Installation	4
Know your device	4
Where to place your Sensedge Go	4
Power Options	5
Sensor Modules	6
Control and Status	7
How to factory reset	7
Device status light indications	7
Installing the Sensedge Go	8
What you will need	8
1. Set up a gateway	8
2. Setting up a Sensedge Go	8
3. Surface mount (using double-sided tape)	9
How to remove the device from the backplate	11
How to remove the backplate from the wall when using double-sided tape	11
Alternative surface-mounting options for the device	12
Drywall	13
Surface Mount using Electrical Box Mount (US/EU Version)	14
Temporary install	15
FCC Statement	16
Declaration of conformity	16
Warranty Information	17
Troubleshooting	17

What's Included

In the package



Sensedge Go



Sensedge Go sensor module x 1 (in the device)



3.6V Li-ion batteries x 6 (in the device)



Certificate of calibration and testing

On the underside of the bottom tray in the packaging

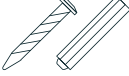

Drywall screws and anchors (2 pairs)



Electrical box screws (US) x 2



Electrical box screws (EU) x 2



Gateway

This product requires a Kaiterra Gateway for operation, which is not included. Please ensure you have one available prior to initiating the installation process.

Important Safeguards

Please read the safety warnings before use and take the necessary precautions to reduce the risk of fire, electric shock, or injury. The Kaiterra limited warranty applies only if the unit is used according to these instructions. Kaiterra will not be liable for any damages, injuries, or losses resulting from use of the product that does not comply with these instructions or the safety warnings provided.

WARNING 

- To reduce safety risks, always use service personnel from the manufacturer or service provider, or other qualified personnel for installation and maintenance.
- Make sure the power is OFF during installation or maintenance.
- ONLY use 3.6V ER14505 Li-SOCL₂ batteries
- DO NOT tamper with or use nonofficial spare parts for repair or maintenance.
- DO NOT use the device in environments with high humidity or possible direct exposure to water.
- DO NOT use the device in an outdoor environment.
- DO NOT use the device near heat sources such as radiators, furnaces, ovens, or stoves.

Getting Ready for Installation

Know your device

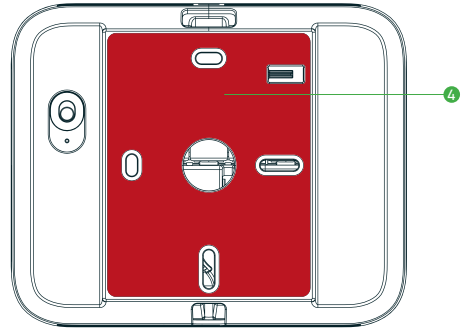
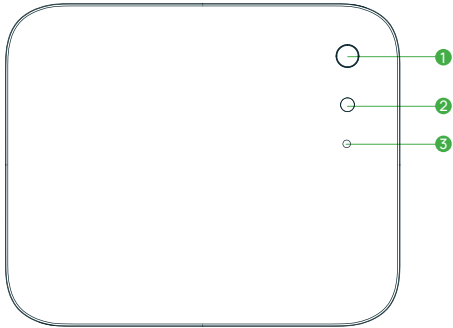

- 1 PIR sensor
- 2 Light sensor
- 3 LED
- 4 Double-sided tape
- 5 External antenna port
- 6 Power button
- 7 Reset button
- 8 Moudule bays
- 9 Moudule bays
- 10 Batteries
- 11 USB-C 5V/0.5A
- 12 External antenna connection point

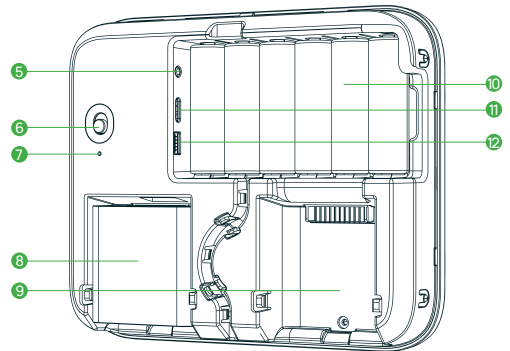

Where to place your Sensedge Go

Install your device in occupied space at 1.1-1.7m (3.6-5.6 ft) above the floor (away from doors, windows, air supply and zones where occupants may exhale directly into the sensor). Please make sure that your desired mounting location is close to a power source.

The Sensedge Go draws air in from the lower side and releases it from the upper side. It is essential to keep both sides unobstructed, as any disruption to the airflow can impact the device's readings and accuracy.

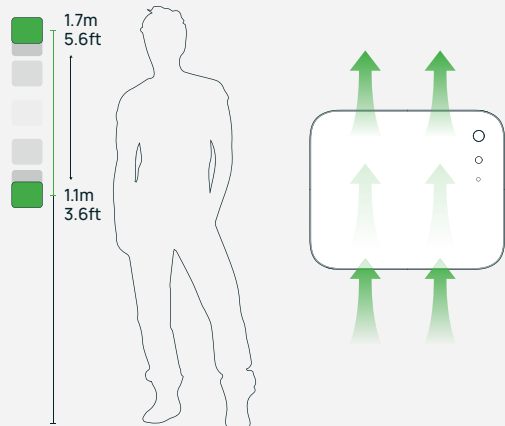

Power Options

The Sensedge Go provides 2 power options:

3.6 V AA Li-SOCl₂ batteries

The Sensedge Go is designed to operate with 1 to 6 batteries, allowing flexibility in power configurations. Always use 3.6V ER14505 Li-SOCl₂ batteries for optimal performance. **Do not use rechargeable batteries**, as they may damage the device.

To remove the batteries, use a flat-head screwdriver to gently push the far-right battery out of its compartment. When installing new batteries, ensure proper placement: insert each battery with the positive terminal (+) aligned with the top contact and the negative terminal (-) aligned with the bottom contact, following the orientation guide inside the compartment.

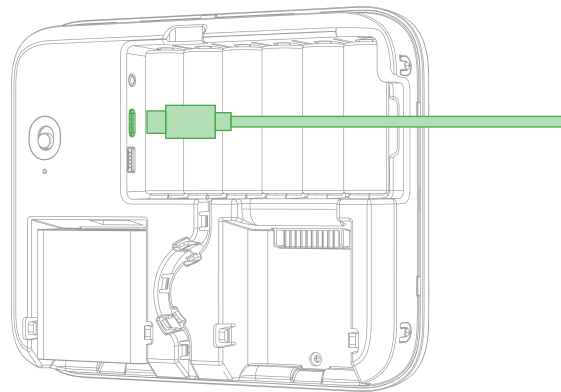
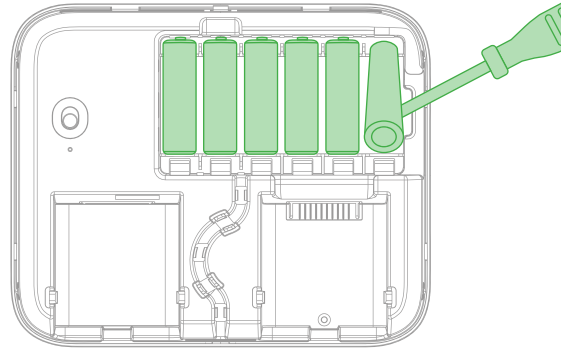

USB-C (USB-C power cable not included)

The Sensedge Go is equipped with a 5V/0.5A USB-C port, located on the left side of the battery bay. This port provides a reliable and convenient option for powering the device in addition to battery operation. Ensure compatibility with the specified power output for optimal performance.

The Sensedge Go offers flexible routing options for the USB-C cable, allowing it to exit from the top, bottom, or rear of the device (through an opening in the drywall or an electrical box). All exit points are equipped with built-in cable strain reliefs to secure the cable in place, preventing overpulling and reducing the risk of damage.

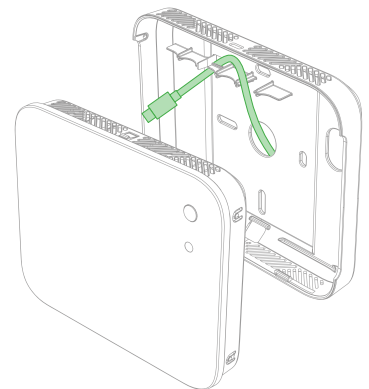
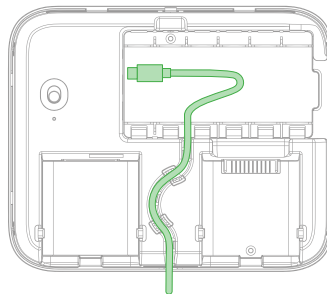
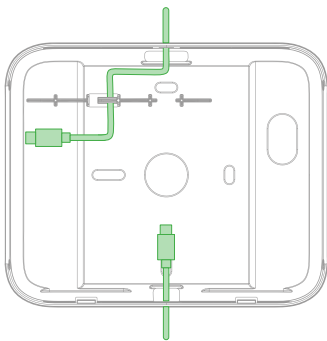

To ensure proper installation, make sure the cable is securely fitted into the designated cable slot. The bottom exit can accommodate up to 2 cables: 1 x 3mm and 1 x 4mm cables. The top exit can accommodate multiple cables.

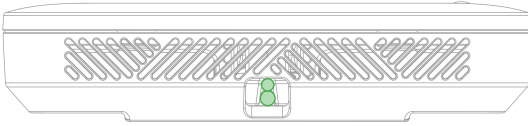

The bottom exit

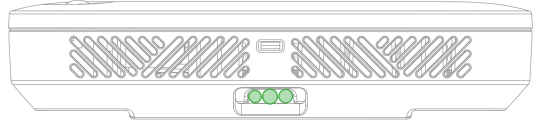

The top exit

Sensor Modules

Sensors may be inserted in either sensor bay, and in any order. They may be swapped both when the Sensedge Go is powered on and operational, and when the device is turned off.

To insert a sensor module, align it head-first with the bay, press it in, and ensure it clicks into place securely. To remove a sensor module, lift the module from the bottom up.

To insert a sensor module, align it head-first with the bay, press it in, and ensure it clicks into place securely. To remove a sensor module, lift the module from the bottom up.

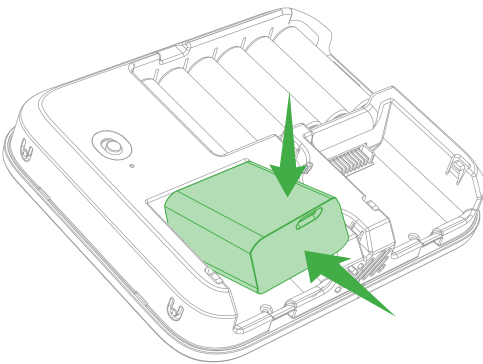

Insert

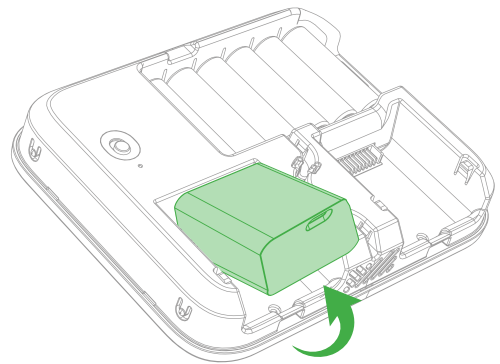

Remove

Control and Status

Move the ON/OFF switch up to turn on the device. After several seconds, the STATUS light will light up blue to indicate the device has been powered on.

To reset the device, use a paperclip or pin and hold down the RESET pinhole. The STATUS light will flash red rapidly, indicating that the reset is successful.

How to factory reset

To clear all settings and put the Sensedge Go back into its factory state:

1. Locate the reset hole on the back of the Sensedge Go, below the power switch.
2. Turn on the device and wait for it to boot up fully, confirmed when the blue LED light turns off.
3. Insert a pin or similar object into the reset hole.
4. Press and hold the Reset button inside the hole for about 10 seconds.
5. Release the button when the LED begins blinking rapidly in blue, indicating the device has been reset to factory settings.

Device status light indications

Device State	LED Behaviour
Booting up	Solid blue for 4 seconds
Waiting for configuration	Pulse orange every 1 second
Searching for / connecting to gateway	Pulse orange every 3 seconds
Connected to gateway	Solid blue for 4 seconds
Factory-reset countdown	Blink blue for the final 10 seconds of the countdown
Factory-reset confirmed	Fast blink orange

Installing the Sensedge Go

The Sensedge Go can be mounted on a smooth surface like concrete block wall, drywall, wooden panels, glass, or to an electrical box.

What you will need



Sensedge Go



Sensedge Go sensor module (already assembled in device)



Gateway



Gateway antenna



Gateway power adapter



The Kaiterra app (app store link, APK link)

1 Set up a gateway

- a. Attach the gateway antenna
- b. Connect gateway to Ethernet, unless this installation will be using the included SIM card (fees apply).
- c. Connect gateway to power.
- d. Wait 4 minutes. Removing power before the gateway is fully booted up can lead to errors or failure.

2 Setting up a Sensedge Go

- a. Turn on the Go by sliding the switch on the back of the device upwards (batteries are pre-installed in the device by default)
- b. Check the front panel to confirm the power connection; the status LED will illuminate blue for a few seconds, followed by blinking orange.

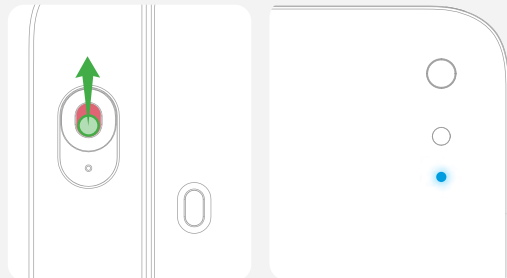

- c. Log in to Kaiterra app on a mobile device.
- d. Follow the instructions in the mobile app to set up your device.
- e. Log into the Kaiterra dashboard to see your IAQ data!

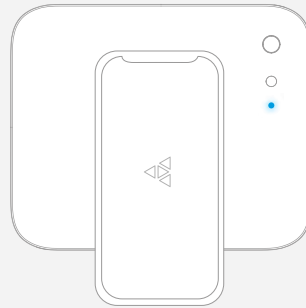

3 Surface mount (using double-sided tape)

A. Prepare mounting surface

- a. Ensure the surfaces are smooth, clean, and dry. For optimal preparation, clean using a 50:50 mixture of isopropyl alcohol (IPA) and water, or heptane.
- b. Wipe dry



B. Adhere device to wall

Peel off the liner from the double-sided tape and firmly press the device onto the specified location on the wall. Apply pressure during installation to ensure optimal adhesive contact. Allow the adhesive to set by leaving it undisturbed for 24 hours.

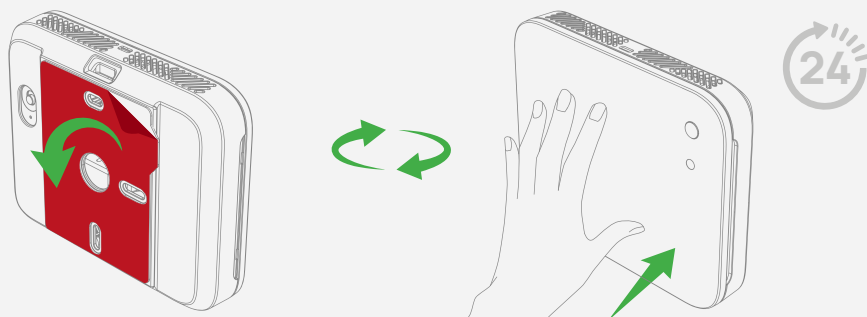

For how to remove the device from backplate, or how to remove an installed device off the wall, or alternative ways to install the Sensedge Go, please see the next section



**Installation
complete**

How to remove the device from the backplate

The back cover of the Sensedge Go also serves as a wall mount.

To remove the back cover, insert a flat-head screwdriver (5mm or 3/16 inch) or pin into the slit at the top of the device. Apply gentle pressure to release the device slightly, then pull it forward to detach it from the cover.

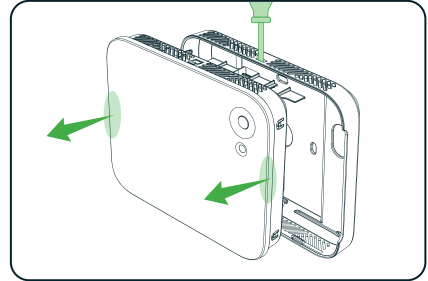

To put the device back into the back cover, first place the bottom of the device into the cover. Then, press the top of the device into place until you hear a click, indicating it is securely fastened.

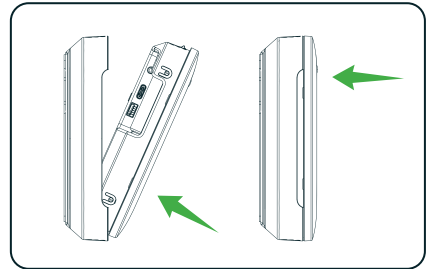

How to remove the backplate from the wall when using double-sided tape.

* Do not peel off by force, as this may damage the wall.

1 Remove the device

2 Use a heat gun to warm up the tape and soften the adhesive.

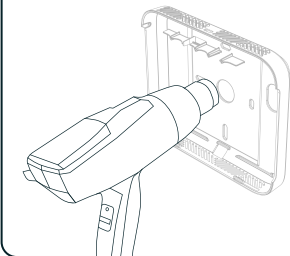

3 Peel off the backplate slowly, or use a fishing line to slide behind the tape for easier removal.

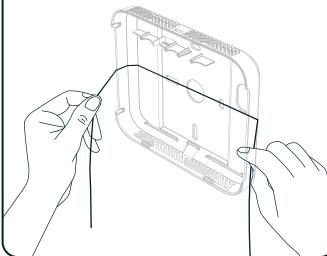

4 Clean the wall with adhesive cleaner or remover to eliminate any remaining adhesive residue.



Alternative surface-mounting options for the device

Drywall

1. Additional tools you will need



Drywall screws
(M4*25mm) x 2



Drywall anchors
(M6*25mm) x 2



Cross screwdriver

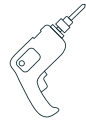

Power drill

2. Prepare for drywall cut

- 1 Remove the back plate and position it at the desired installation location. Use a pencil to mark the positions of two opposite screw holes (top and bottom or left and right) and trace along the inside edge of the cutout.

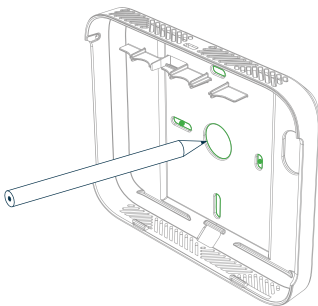

- 2 Cut along the marked line (if powering using in-wall power)

Create an incision along the penciled line using your drywall cutting tool. Please check for built-in conduits and cables in the wall before cutting.

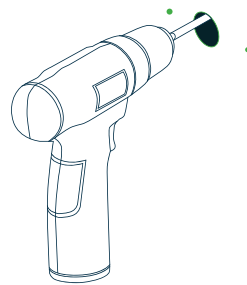

3 Drill holes for anchors

Use your power drill and 6mm drill bit to create three holes at the marked screw hole locations.

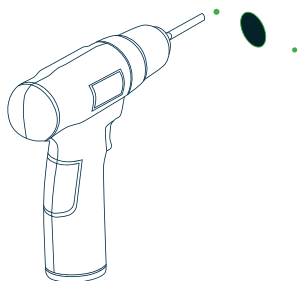

4 Placing anchors in the wall

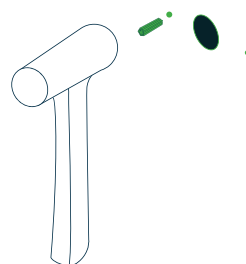

5 Mount backplate to the wall

Line up the backplate with your Drywall Anchors and mount it to the wall using provided Drywall Screws

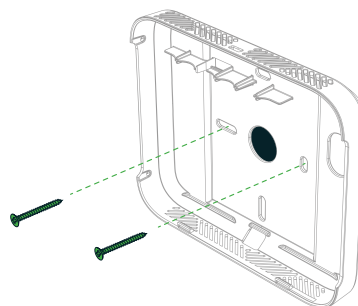

- 6 Power the device
- 7 Turn on the device and check for power connection
- 8 Secure the device onto the back plate by snapping it into place.

Surface Mount using Electrical Box Mount (US/EU Version)

1. Additional tools you will need



Drywall screws
(M4*25mm) x 2



Drywall anchors
(M6*25mm) x 2

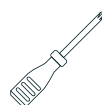

Cross screwdriver



Power drill

2. Install backplate

- 1 Install device backplate over electrical box

Line up the device backplate with your in-wall electrical box and mount it in place using provided Electrical Box Screws and the two screw holes indicated below.

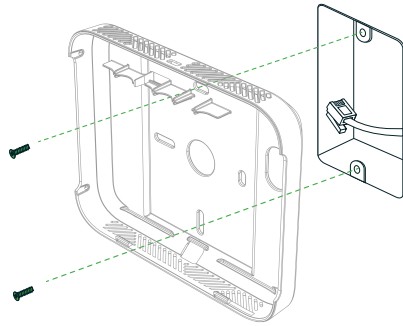

- 2 Power the device
- 3 Turn on the device and check for power connection
- 4 Secure the device onto the back plate by snapping it into place.

Temporary install

1. Additional tools you will need



2 Pairs 3M Command™ Large Picture Hanging Strips (with velcro)

2. Prepare mounting surface

- 1 Wipe wall with rubbing alcohol. Do not use household cleaners or water.



- 2 Separate strips. Click strips together.

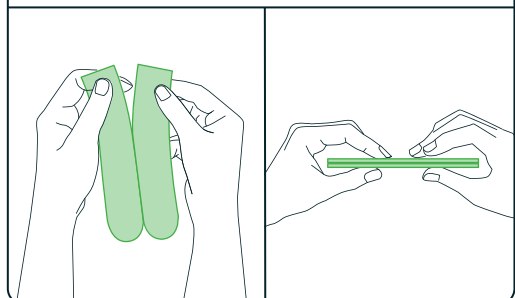

- 3 Remove one side of liners. Stick on frame as shown. Press firmly.

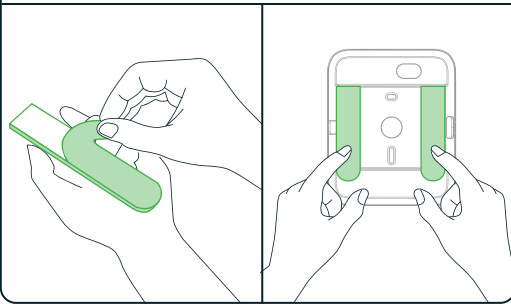

- 4 Remove remaining liners. Press the device firmly to the wall.

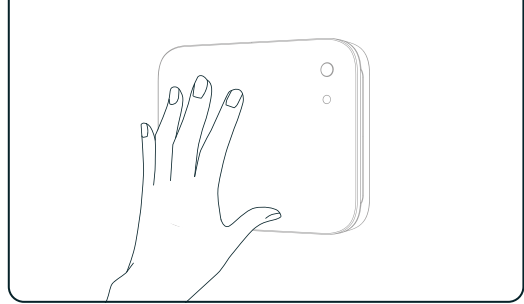

How to remove temporary installation

- 1 Grab bottom corners and peel device from wall.
Do not pull straight off.

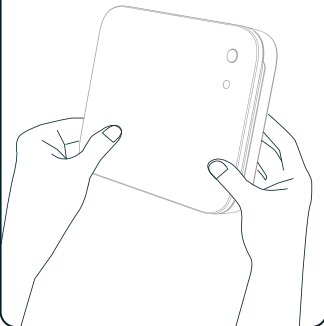

- 2 Never pull away from the wall.

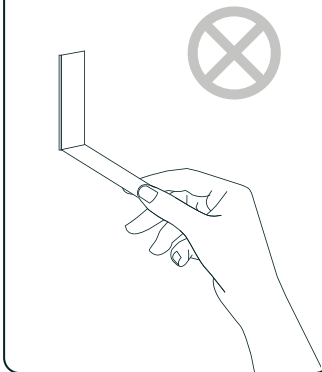

- 3 Pull easy-off stretch strips slowly down against the wall at least 15 inches (38 cm) to release.

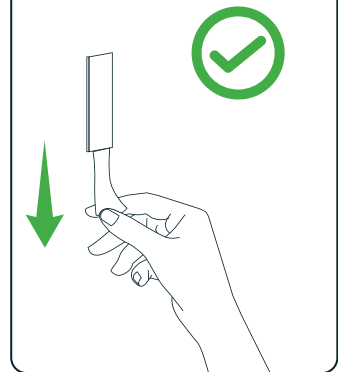

FCC Statement

This equipment has been tested and found to comply with the limits for a Class B digital device, pursuant to part 15 of the FCC Rules. These limits are designed to provide reasonable protection against harmful interference in a residential installation. This equipment generates, uses and can radiate radio frequency energy and, if not installed and used in accordance with the instructions, may cause harmful interference to radio communications. However, there is no guarantee that interference will not occur in a particular installation. If this equipment does cause harmful interference to radio or television reception, which can be determined by turning the equipment off and on, the user is encouraged to try to correct the interference by one or more of the following measures:

- Reorient or relocate the receiving antenna.
- Increase the separation between the equipment and receiver.
- Connect the equipment into an outlet on a circuit different from that to which the receiver is connected.
- Consult the dealer or an experienced radio/TV technician for help.

Caution: Any changes or modifications to this device not explicitly approved by manufacturer could void your authority to operate this equipment.

This device complies with part 15 of the FCC Rules. Operation is subject to the following two conditions: (1) This device may not cause harmful interference, and (2) this device must accept any interference received, including interference that may cause undesired operation.

RF Exposure Information

This equipment complies with FCC radiation exposure limits set forth for an uncontrolled environment. This equipment should be installed and operated with minimum distance 20cm between the radiator and your body.

Specifications

Hardware Version	V6.1
Software Version	V0.2.7
Working Temperature	-20°C~50°C
Gateway-device communication frequency	867MHz ~ 868MHz (Max. EIRP: 13.81dBm), or 902~914.2MHz, depending on region
NFC Receiver	13.56MHz
SAR	The device complies with RF specifications when the device used at 20cm from the body of the user or nearby persons

Declaration of conformity

Origins Technology Limited declares that this Sensedge Go is in compliance with the essential requirements and other relevant provisions of Directive 2014/53/EU. In accordance with Article 10(2) and Article 10(10), this product is allowed to be used in all EU member states.

Manufacturers shall ensure that radio equipment shall be so constructed that it can be operated in at least one Member State without infringing applicable requirements on the use of radio spectrum.

Applicant: Origins Technology Limited

Address: 603 6/F, Laws Commercial Plaza, 788 Cheung Sha Wan Road, Hong Kong

Manufacturer: Origins Technology Limited

Address: 603 6/F, Laws Commercial Plaza, 788 Cheung Sha Wan Road, Hong Kong

Warranty Information

Kaiterra provides a 1-year limited manufacturer warranty on the Sensedge Go. To obtain a copy of the warranty for this product, please visit <https://support.kaiterra.com/policies>

Troubleshooting

For additional support, please contact your sales representative or email us at support@kaiterra.com